



**INSPECTION
CERTIFICATE**

INSIDE MICROMETERS

INSIZE PLUS
MADE IN EUROPE



3679-55

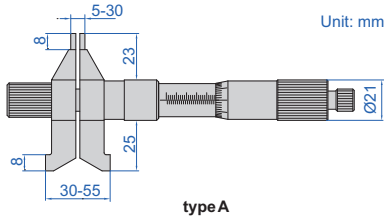

type A



3679-75

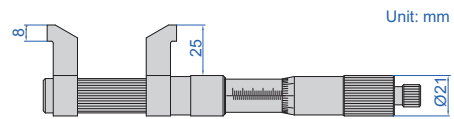

type B

for type A, the upper jaws and lower jaws can be set zero separately



- Graduation: 0.01mm
- Carbide measuring faces
- Ratchet stop
- Optional accessory: setting ring (code **6312**), caliper/height gauge checker (code **6884**)

| Code | Range | Type | Accuracy |
|------------|-----------|------|----------|
| 3679-55 * | 5-55mm | A | 4µm |
| 3679-75 * | 50-75mm | B | 5µm |
| 3679-100 * | 75-100mm | B | 6µm |
| 3679-125 * | 100-125mm | B | 7µm |
| 3679-150 * | 125-150mm | B | 8µm |
| 3679-175 * | 150-175mm | B | 9µm |
| 3679-200 * | 175-200mm | B | 9µm |
| 3679-225 * | 200-225mm | B | 10µm |
| 3679-250 * | 225-250mm | B | 10µm |
| 3679-275 * | 250-275mm | B | 12µm |
| 3679-300 * | 275-300mm | B | 12µm |

* Supplied with manufacturer inspection certificate

| Code | Range | Type | Accuracy |
|------------|-----------|------|----------|
| 3679-325 * | 300-325mm | B | 15µm |
| 3679-350 * | 325-350mm | B | 15µm |
| 3679-375 * | 350-375mm | B | 16µm |
| 3679-400 * | 375-400mm | B | 16µm |
| 3679-425 * | 400-425mm | B | 17µm |
| 3679-450 * | 425-450mm | B | 17µm |
| 3679-475 * | 450-475mm | B | 18µm |
| 3679-500 * | 475-500mm | B | 18µm |
| 3679-525 * | 500-525mm | B | 19µm |
| 3679-550 * | 525-550mm | B | 19µm |
| 3679-575 * | 550-575mm | B | 20µm |
| 3679-600 * | 575-600mm | B | 20µm |

**ATTENTION: LOW PARALLELISM
OF TWO MEASURING FACES**

micrometer stand
with clamp (optional)



- Graduation 0.01mm
- Ratchet stop
- Carbide measuring faces
- Optional accessory: setting ring (code **6312**), micrometer stand and clamp (code **6301** and **6301-1**)

| Code | Range | Type | Setting ring | Accuracy |
|----------|----------|------|-----------------|----------|
| 3220-30 | 5-30mm | A | 5mm (included) | 7µm |
| 3220-50 | 25-50mm | B | 25mm (included) | 8µm |
| 3220-75 | 50-75mm | B | 50mm (optional) | 9µm |
| 3220-100 | 75-100mm | C | 75mm (optional) | 10µm |

INSIDE MICROMETERS (ECONOMIC TYPE)

Unit: mm

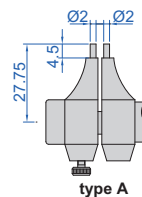

type A



3220-50

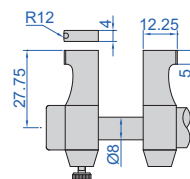

type B

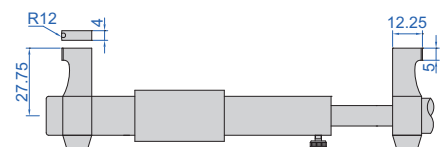

type C

DIGITAL INSIDE MICROMETERS (ECONOMIC TYPE)

DATA
OUTPUT

ATTENTION: LOW PARALLELISM
OF TWO MEASURING FACES

- Resolution 0.001mm/0.00005"
- Button function: on/off, set, mm/inch, data transmit
- Data output
- Automatic power off
- Ratchet stop
- Carbide measuring faces
- Optional accessory: wireless transmitter code **7315-31** (receiver is needed) page 6, bluetooth transmitter code **7214-31** page 12, data output cable code **7302-31** page 20, setting ring (code **6312**)



3520-30

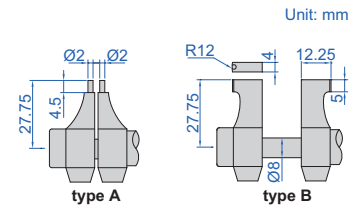

| Code | Range | Type | Setting ring | Accuracy |
|----------|-----------------|------|-----------------|----------|
| 3520-30 | 5-30mm/0.2-1.2" | A | 5mm (included) | ±5µm |
| 3520-50 | 25-50mm/1-2" | B | 25mm (included) | ±6µm |
| 3520-75 | 50-75mm/2-3" | B | 50mm (optional) | ±7µm |
| 3520-100 | 75-100mm/3-4" | C | 75mm (optional) | ±8µm |

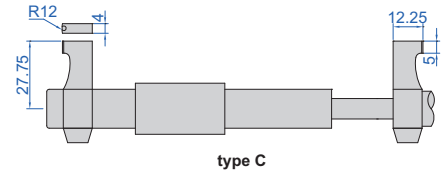

7

INTERNAL GEAR TOOTH MICROMETERS

INSIZE PLUS
MADE IN EUROPE

INSPECTION
CERTIFICATE

- Measure over-pin diameter of gears
- Graduation: 0.01mm
- Ratchet stop
- Optional accessory: ball tips (code **7383**)

before ball tips
are installed



ball tips are optional



3678-50

| Code | Range | Accuracy | L |
|----------|---------|----------|-----|
| 3678-50* | 25-50mm | 4µm | 6mm |
| 3678-75* | 50-75mm | 5µm | 8mm |

*Supplied with manufacturer inspection certificate

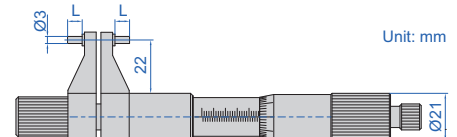
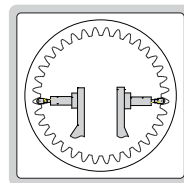

TUBULAR INSIDE MICROMETERS

- Graduation 0.01mm
- Accuracy: (6+L/50)µm
L=maximum measuring length (mm)
- Optional accessory: setting ring (code **6312**), gauge block accessory (code **6881**), cylinder gauge block (code **4001**), caliper/height gauge checker (code **6884**)



3221-200

| Code | Range | Travel of micrometer head | Extension rods |
|-----------|------------|---------------------------|----------------|
| 3221-32 | 25-32mm | 7mm | — |
| 3221-50 | 25-50mm | 7mm | 2 pcs |
| 3221-63 | 50-63mm | 13mm | — |
| 3221-200 | 50-200mm | 13mm | 6 pcs |
| 3221-300 | 50-300mm | 13mm | 10 pcs |
| 3221-225 | 200-225mm | 25mm | — |
| 3221-500 | 200-500mm | 25mm | 3 pcs |
| 3221-1000 | 200-1000mm | 25mm | 8 pcs |

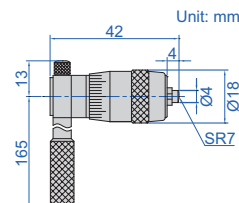

application

